



AN ISO 9001 : 2008 CERTIFIED CO.

SYMBOL OF QUALITY

Pioneers In Solderless Terminals,
Crimping Tools & Cable Glands



BI-METALLIC CABLE LUGS & CONNECTORS (Friction Welding)

**House of Designers & Makers of Terminals,
Tools & Cable Glands Since 1961**

Catalogue 2016

BI-METALLIC TERMINALS

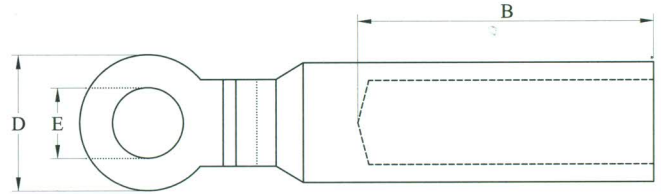
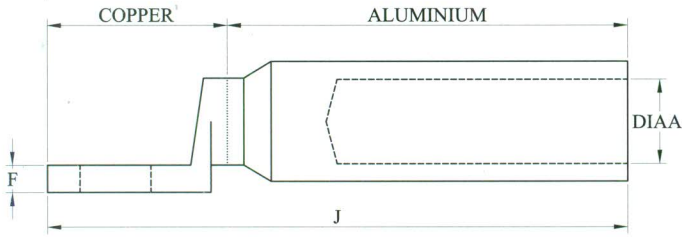

Sr. No.	Dowell's Cat. No.	Size (Sq-mm)	E	DIA A	B	F	D	J
1	CAF 25-10	25	10.5	7.5	30	4	19	70
2	CAF 35-10	35	10.5	8.5	30	4	19	70
3	CAF 50-13	50	13	10.2	35	5	24	85
4	CAF 70-13	70	13	11.5	45	5	24	90
5	CAF 95-13	95	13	13.5	50	5	24	95
6	CAF 120-13	120	13	15.5	55	6	30	105
7	CAF 150-13	150	13	16.5	60	6	30	110
8	CAF 185-13	185	13	18	60	7	35	130
9	CAF 240-13	240	13	22	65	7	35	135
10	CAF 300-17	300	17	23.5	70	7.5	36	140
11	CAF 400-17	400	17	26.5	75	7.5	36	145
12	CAF 500	500	-	30	95	10.5	50	200
13	CAF 630	630	-	34	95	10.5	60#	200

Note :-

*All Dimensions are in mm

*Raw Materials : (Copper : E. C. Grade as per IS-191)

(Aluminium : E. C. Grade as per IS - 5082)

*Tolerances : +/- 5%

Joining Method : Friction Welding

*# Square Palm of Given Dimension with as per Required E Hole

*Recommended Crimping Tool SYE -150 B

